

TEMPLATE INSTRUCTIONS

Please read the important information below first, and follow the full 'Fitting Instructions' supplied in the tray.

1. Place the shower tray in the required position on the floor
2. Mark out the center point of the tray waste hole with a cross '+'
3. Move the tray to a safe location to prevent accidental damage
4. Cut out the template (right)
5. Position the template using the cross mark to align with the cross already marked on the floor (see enclosed 'Fitting Instructions' - 1)
6. Ensure the position of the template aligns correctly with the plumbing waste outlet
7. With a pencil, mark around the template onto the floor
8. Cut out the marked floor area with the correct tools
9. Ensure that the hole is not cut oversized

IMPORTANT INFORMATION

General

Use the template guide **ONLY** to cut out the waste area. This will ensure minimum stress to the shower tray. Failing to do so, may weaken the shower tray and cracking may appear.

Wood Floor

It is essential that all floor boards are properly secured, ensuring no movement or flex. Any joints in floor boards that are not supported by a joist must be supported by a separate noggin. Any floor boards that flex between joists **MUST** also be supported by additional noggin(s).

Ensure that floorboards around the waste hole are fully supported by noggins. There must be no floor movement around the cut hole.

See full 'Fitting Instructions' for detailed drawings.

WASTE UNIT INSTRUCTIONS

- Only use the waste unit provided. Fitting an alternative waste unit will compromise water flow.
- It is strongly recommended that a qualified plumber completes the waste unit installation and final plumbing
- To locate waste unit, apply a seal of silicone (if required) to the waste area, apply plastic flange and locate onto waste unit with the securing screws supplied.
- To join waste pipe to waste unit, use either a compression fitting or solvent weld fitting as preferred (both supplied). **Please note:** If using solvent weld, test for leakage and seal by pouring approximately 2 litres of water into waste unit prior to final fitting.
- It is essential that the fall angle of the waste pipe is maximised. Fall must be a **MINIMUM** of 2% to ensure adequate water flow.

For trouble shooting and Q&A's, please visit www.wirquin.com

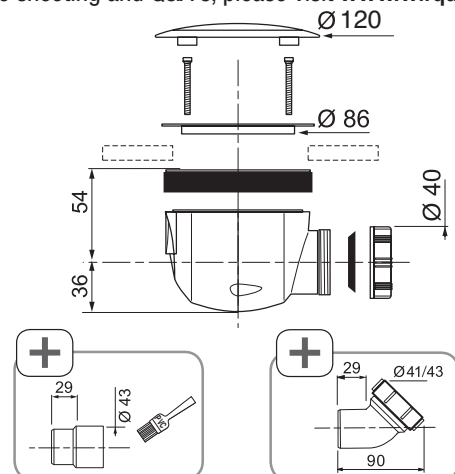



bathstore

TROUBLE SHOOTER SHOWER WASTE

SOLID FLOOR INSTALLATION

✓OK



CAVITY FLOOR INSTALLATION

✓OK

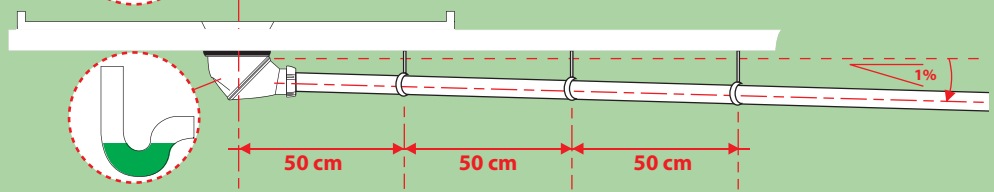

ADDITIONAL RECOMMENDATIONS

- Check that the filter is correctly fitted in the waste and remember to clean it from time to time to prevent any blockage build up (hair, etc).
- Ensure that the waste inlet is protected when fitting or renovating the shower so as to avoid any debris falling into the trap body.
- Correctly tighten the grid (using the red key if provided) to ensure a watertight seal (a bead of sealant on the underside of the flange may assist in overcoming any irregularities in seating in the tray).
- If the shower tray overflows in use: Calculate the number of litre/ minute flow rate. If less than 24L/min the waste may not conform to standards (time how long it takes to fill using 5 to 10 litres to work out the flow rate).

PROBLEMS

Reduced or even zero flow rate

CAUSES

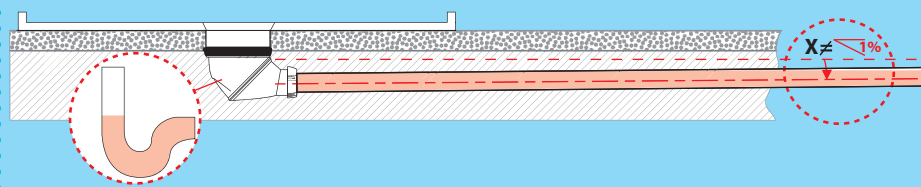

SOLUTIONS

Re-install (Use the correct installations above as a model) check that there is the required minimum 1% slope.

Do not use 90 degree bends if at all possible: any sharp bend or series of bends/joints will adversely affect the flow rate.

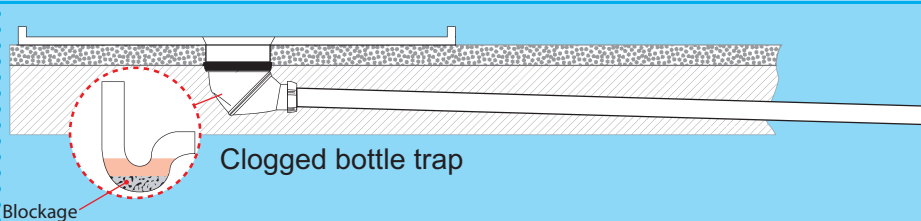

Clean using a pump.

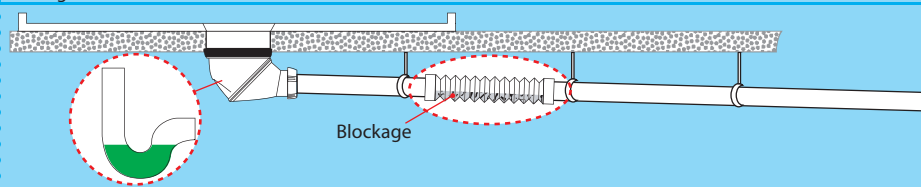
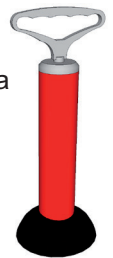

INCORRECT INSTALLATION



Do not embed a flexible pipe solution unless access is possible.

*Water flows back into the shower tray
Trap flow rate problems*

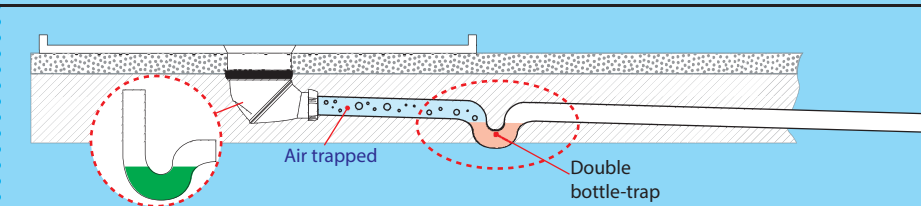

Re-install (Use the correct installations above as a model). Get rid of second bottle trap.

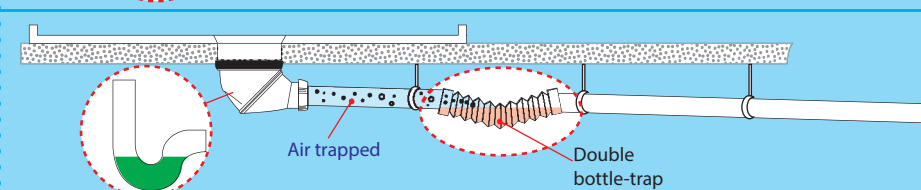

Install the flexible pipe solution correctly or replace it. Do not use a flexible pipe solution unless access is possible.

Tube vibration, water leaking from the seal

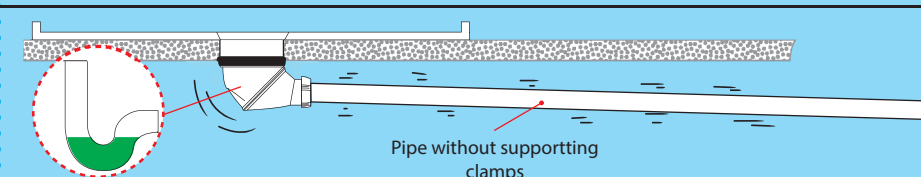

Fit pipe supporting clamps (use the correct installations above as a model).